

REPORT ON THE
2018 EXCAVATIONS



AT THE
C-3 JOHN AND ELIZABETH HOWLAND
HOMESITE

By
Craig S. Chartier
Plymouth Archaeological Rediscovery Project

For the
Pilgrim John Howland Society

December 2018

In September of 2017, PJHS members, archaeologists and volunteers, tested the southwest corner of the John and Elizabeth Howland Homestead (**Figure 1**). One of the goals was to investigate piles and possible linear arrangements of stones encountered during brush removal in this area. It appears that, this year, we discovered a previously unknown building in the central area of our excavation. It may be a northern extension of the building associated with the western cellarhole, or it may be a separate building in the northern yard. The artifacts associated with it appear domestic in nature, specifically the bone and ceramics, so it probably was not a barn or outbuilding. Excavation of the units to the east and north have shown that no building remains are present in those areas.

Further excavation around the area we excavated in 2017 was recommended. It appeared that we had found traces of at least one previously unknown building at the site, a building that, due to the orientation of stones we had thus far uncovered, was felt to probably not date to the John and Elizabeth Howland period and which did not appear to have been impacted by Strickland's excavations.

2018 Field Testing

The field crew excavated a total of 10 units of various sizes this year, totaling 40 square feet (**Table 1**).

Table 1. 2018 testing summary

2018 Unit	Size	Square Feet	Location
1	5 x 5'	5	West
2	5 x 5'	5	West
3	5 x 5'	5	South
4	5 x 5'	5	South
5	5 x 5'	5	West
6	2.5' N-S, 5' E-W	2.5	West
7	2.5' N-S by 5' E-W	2.5	West
8	5 x 5'	5	West
9	2.5' N-S, 5' E-W	2.5	West
10	2.5' N-S, 5' E-W	2.5	West
Total		40 Square Feet	

In addition to the new units that were opened this year, several units that had been opened the previous year were reopened (2017-8, 10, 11, 14, and 15) (**Figure 1**).

The 2018 work focused on expanding and more completely exploring the area we worked at in 2017, the southwest portion of the yard between the John and Elizabeth Howland house and the later building cellar hole towards the road. We re-exposed the area that we worked in the previous year to see how extensive the low stone foundations from 2017 were and when they dated to. Our 2018 excavations showed that they appear to represent another building on the property, what appears to be an outbuilding measuring approximately 9 feet east to west by 16 feet north to south (**Figures 2, 3, 4, and 5**). The building is not oriented exactly the same as either the John and Elizabeth house or the later

cellar holes, meaning that it may date to a different time period than either. It could date to the period after John's death when Joseph was living across the street, possibly representing an outbuilding of his farm; that it may date to after his occupation to the period when Benjamin Lothrop owned the property, again representing an outbuilding; or that it dates to earlier than then the Howland occupation, possibly representing an outbuilding associated with the occupation of the site by John Jenney.

Excavation of a portion of foundation wall showed that it appeared to represent a modification to an earlier post-in-ground building (**Figures 6 and 7**). The artifacts recovered from the excavation of the postholes appear few and far between, supporting an interpretation of the features being early and possibly associated with Jenney. The working hypothesis is that this was one of the outbuildings that was built on the site by Jenney and sold to John in February 1638/39 “..a house, barn and out-buildings at Rocky Nook, with its uplands and five acres of adjoining meadow”. The building may have started out as post-in-ground and as the post decayed, they were replaced with a low stone foundation. Further investigation of this building next year will help to test this hypothesis. The other area investigated was the southern area between the two later cellarholes. Here Eldon Gay identified a flat stone platform between the cellarholes that may represent a working surface associated with the building, possibly a floor within a barn, or the base of a chimney (**Figure 8**).

Artifacts

Fieldwork this year resulted in the recovery of a total of 832 pieces of prehistoric and historic material cultural material (**Tables 2 and 3**). Significant artifacts from this year's excavations included a brass mouth harp, which offered us a rare opportunity to hear a sound from the 17th century that John and Elizabeth would have heard and enjoyed; a complete Native arrowhead of a style associated with the Pilgrim Period; an early (1620-1650) tobacco pipe fragment; brick fragments that may have been displaced from the Howland house; and lots of shell fragments that may date to after the Howland occupation (**Figure 9**).

Table 2. Summary of artifacts recovered in 2017 and 2018

Artifact	2018 Count	2017 Count
Prehistoric	107/ 12.7%	157/ 3.8%
Quartz	49	140
Chipping Debris	16	30
Shatter	29	106
Bifaces	0	2
Squibnocket Triangle	1	0
Core	3	1
Uniface	0	1
Rhyolite	40	13
Chipping Debris	35	10

Shatter	1	3
Levanna	1	0
Uniface	1	0
Core	1	0
Quartzite	9	2
Chipping Debris	8	2
Shatter	1	0
Saugus Jasper	4	0
Chipping Debris	3	0
Shatter	1	0
Shell-Tempered Pottery	4	1
Grit-Tempered Pottery	0	1
Architectural	176/ 21.1%	2550/ 61.9%
Brick	76	2455
Mortar	34	9
Hand-Wrought Nails	45	47
Window Glass	14	14
Charcoal	7	25
Foodways	537/ 64.5%	1389/ 33.7%
Ceramics	36	62
Redware	30	57
Buff Stoneware	0	1
Staffordshire Slipware	1	1
Tin-Glazed	1	2
English Mottledware	0	1
Fulham Stoneware	3	0
Scraffito	1	0
Bone	99	97
Bird	1	1
Chicken	0	2

Cod	0	2
Calcined	2	16
Sheep	24	7
Swine	6	4
Cattle	17	57
Medium Mammal	48	6
Large Mammal	1	2
Shell	401	1221
Soft Shell Clam	343	958
Quahog	54	249
Surf Clam	3	14
Moon Snail	1	0
Hand Blown Bottles	1	9
Wine Bottle	1	3
Case Bottle	0	2
Thin Pharmaceutical	0	4
Personal Items	11/ 1.3%	18/ .4%
Pewter Button	0	1
Lead Bale Seal	0	1
Mouth Harp	1	0
Iron Buckle Frame	1	0
Kaolin Pipes	7	10
Small belly Bowl	2	1
Bowl with Cartouche	0	1
Bowl Fragment	3	1
8/64" Stem	0	2
7/64" Stem	0	2
6/64" Stem	0	2
5/64" Stem	0	1
4/64"	2	0
Flint	2	6

Gunflint	1	1
Split Pebble	0	1
Chipping Debris	1	4
Other	1/ .1%	7/ .2%
Modern Material	0	4
Modern Wine Bottle?	1	0
Flat Iron Fragment	0	3
Totals	832	4121

Table 3. Breakdown of artifacts recovered in 2018 by unit

Unit	Prehistoric	Architectural	Foodways	Personal	Other	Total
2017-11	3	5	192	1		201
2017-14	2	2	12			16
2017-15	8	8	12	3		31
2018-1	32	34	16	1		83
2018-2	7	8		1		16
2018-3		6				6
2018-5	6	27	130	2		165
2018-6	13	71	144	1		229
2018-7	2		4			6
2018-8	4	4	11			19
2018-9	20	9	5	1	1	36
2018-10	9	3	11	1		24
Total	107	176	537	11	1	832

Table 4. Distribution of main artifact classes

Unit	Architectural	Ceramics	Pipes	Shell	Bone	Quartz	Rhyolite	Quartzite	Saugus Jasper	Native Pottery
2017-11	5		1	188	4	2	1			
2017-14-W	2	4		4	4	1		1		
2017-15-E	5	1	1			3	2			
2017-15-W	3	1	2	10		2	1			

2018-1	34	13		1	1	7	17	5		3
2018-2	8					5	1		1	
2018-3	6									
2018-5	27	1	2	121	9	3	2		1	
2018-6	71	6	1	59	74	8	5			
2018-7	0	3		1		2				
2018-8	4	3		8		2		1	1	
2018-9	9	4			1	8	10	1		1
2018-10	3			9	2	6	1	1	1	
Total	177	36	7	401	95	49	40	9	4	4

The architectural and foodways classes (dominated by brick and shell fragments) again made up the largest portion of this year's assemblage (77.2%). Architectural fragments (brick, mortar, window glass, and hand-wrought nails) were concentrated (in decreasing frequency) in Units 2018-6, 2018-1, and 2018-5 (Table 4).

Shellfish remains were concentrated in Units 2017-11 and 2018-5 and 6. These units were all located at the southern end of the main excavation area and may be connected with the abundance of shellfish remains found in 2017 associated with the later cellarholes. Species represented consisted mostly of soft-shell clam (N=342) and quahog (N=47) with the only other species present being surf clam (N=3).

Bone was scattered across the excavation area with the largest concentration in Unit 2018-6 (Table 4). Four species were represented: Cattle (N=17 fragments), Sheep (N=24 fragments); Swine (N=6 fragments); and Small Duck (N=1 fragment). The majority of the cattle and sheep fragments came from the skull, ribs, and pelvis with fragments of cattle thoracic vertebra, phalanges, and metapodium also present. This differed for the swine fragments, which consisted of mainly limb bones (ulna radius, scapula, tibia) and a few teeth. The bones appear to represent more butchery waste, elements that were consumed but which generally had lower value and were less meaty than elements such as the upper legs, neck, and lower back.

Ceramics were concentrated in Unit 2018-1 (N=13) with lesser concentrations being found in Units 2018-6 (N=6), 2018-9 (N=4) and 2017-14-W (N=4). Other fragments were scattered about in lower concentrations across the excavation area (Table 4). The majority of the fragments were redware, with several fragments from what is believed to be the same redware mug being found in units 2017-15-E, 2018-1, 2018-7, and 2018-9.

Relatively few Tobacco pipe fragments were recovered (N=7) with the majority coming from the 2017 units. Two fragments were found to date to the 18th century, one definitely dated to the 17th, while the remaining fragments were undatable.

Prehistoric artifacts consisted mostly of debitage from making stone tools out of quartz, rhyolite, quartzite, and Saugus Jasper, the last of which must have been traded from the Saugus, Massachusetts

area where it originates. The other raw materials could have been obtained locally from the beaches. Prehistoric material was concentrated in Units 2018-1 (N=32), 2018-9 (N=20), and 2018-6 (N=13). One quartz possible Squibnocket Triangle, dating from the Late Archaic Period (4500-3000 years before present) and one Late Woodland (1000-350 years before present) Levanna point made out of rhyolite were recovered along with four pieces of Late Woodland Native pottery. The pottery and the Levanna point were found in the same unit, making it likely they were deposited at the same time.

Features

The possible foundation was found to consist of larger cobbles with smaller cobbles placed between them possibly as chinking stones. The larger cobbles appear to be concentrated in discrete collections which were hypothesized to represent the locations of a posthole foundation that was subsequently replaced by a cobble one one the posts had rotted. In order to test this theory, one of the concentrations of cobbles as photographed, mapped, and then bisected in order to see what was below them and how the stones related to the soils they rested on and in. This concentration was labeled Feature 2 and the eastern half was excavated (**Figures 6 and 7**). The stones were found to rest on top of a posthole measuring 20 cm in diameter (8”) and extending to 35 cm (10”) below the surface. This was a small posthole, indicating that the building it was associated with was not large but may have been an outbuilding associated with a larger, more substantial house. Artifacts associated with this feature were limited to one quartz flake, a piece of charcoal, a hand-wrought nail, and a fragment each of soft shell clam and quahog shell. The fact that the posthole foundation had been replaced with one constructed of cobbles, indicates that the building continued in use for an extended period of time and was subjected to repair or upgrade over time. This was also the same situation we found in 2016 when were excavated the area of what is believed to be the barn to the east- a post supported building that later received a cobble foundation. The recovery of a limited number of artifacts indicates that the post was dug early on in the occupation of the site and does not represent a later structure erected after the Howland period of occupation.

Interpretation

The 9 x 16' foundation uncovered this year is believed to represent an early outbuilding associated with the Howland farm. The orientation was slightly different from that of the Howland House itself, but this may be a result of the blurring of the actual foundation outline as a result of tumbled foundation stones. The removal of the stones would allow the exposure and tracing of the original postholes, which would provide a clearer picture of the outline of the original building shape.

Recommendations

The 2018 excavation area was covered with plastic at the end of the excavation season and lightly backfilled. It is recommended that the excavation area be re-exposed in 2019 and work continued here in order to investigate the foundation and its associated posthole features.

APPENDIX A
Figures

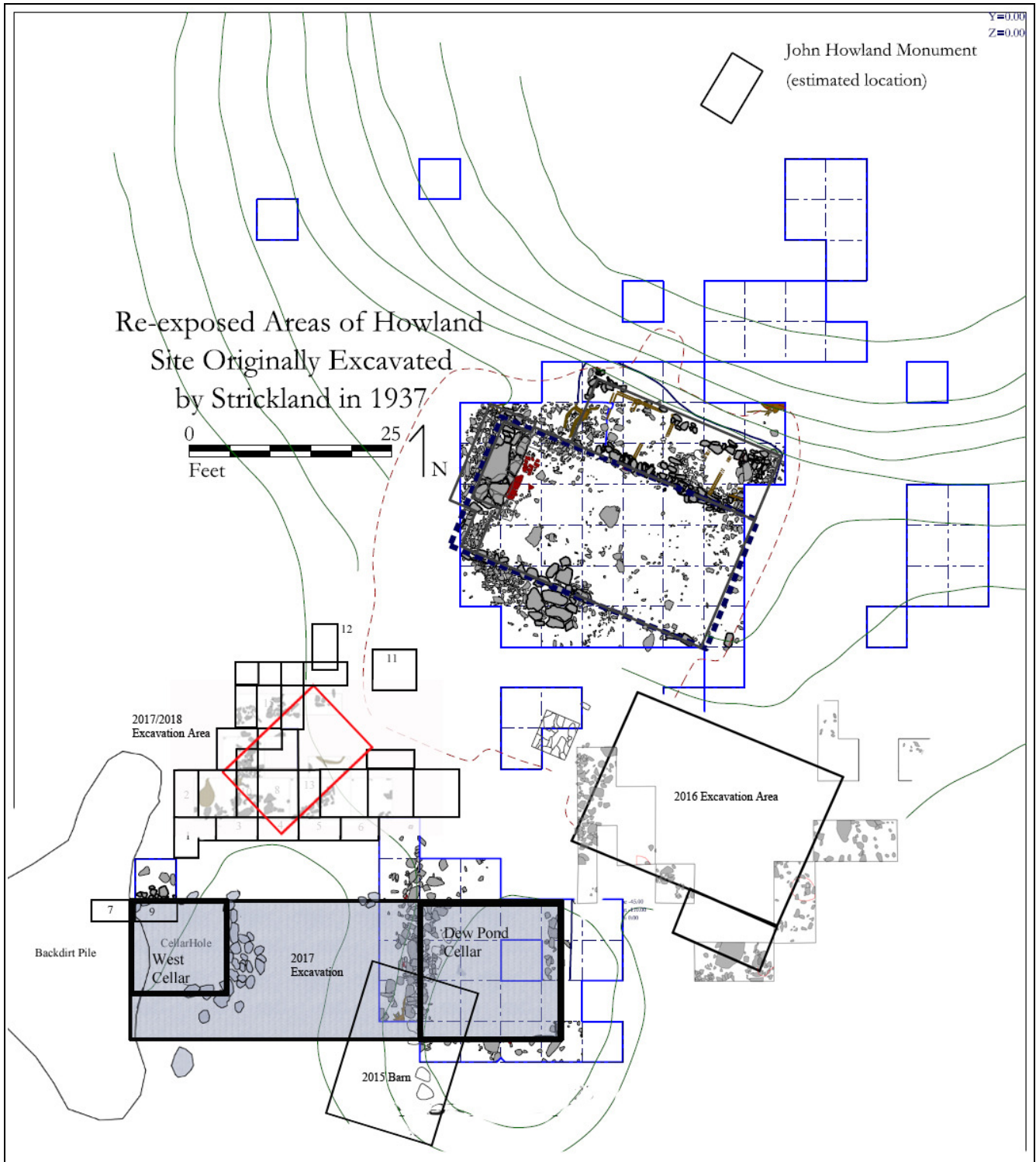

Figure 1. Location of the 2018 testing, possible outbuilding (outlined in red) and other buildings previously identified.

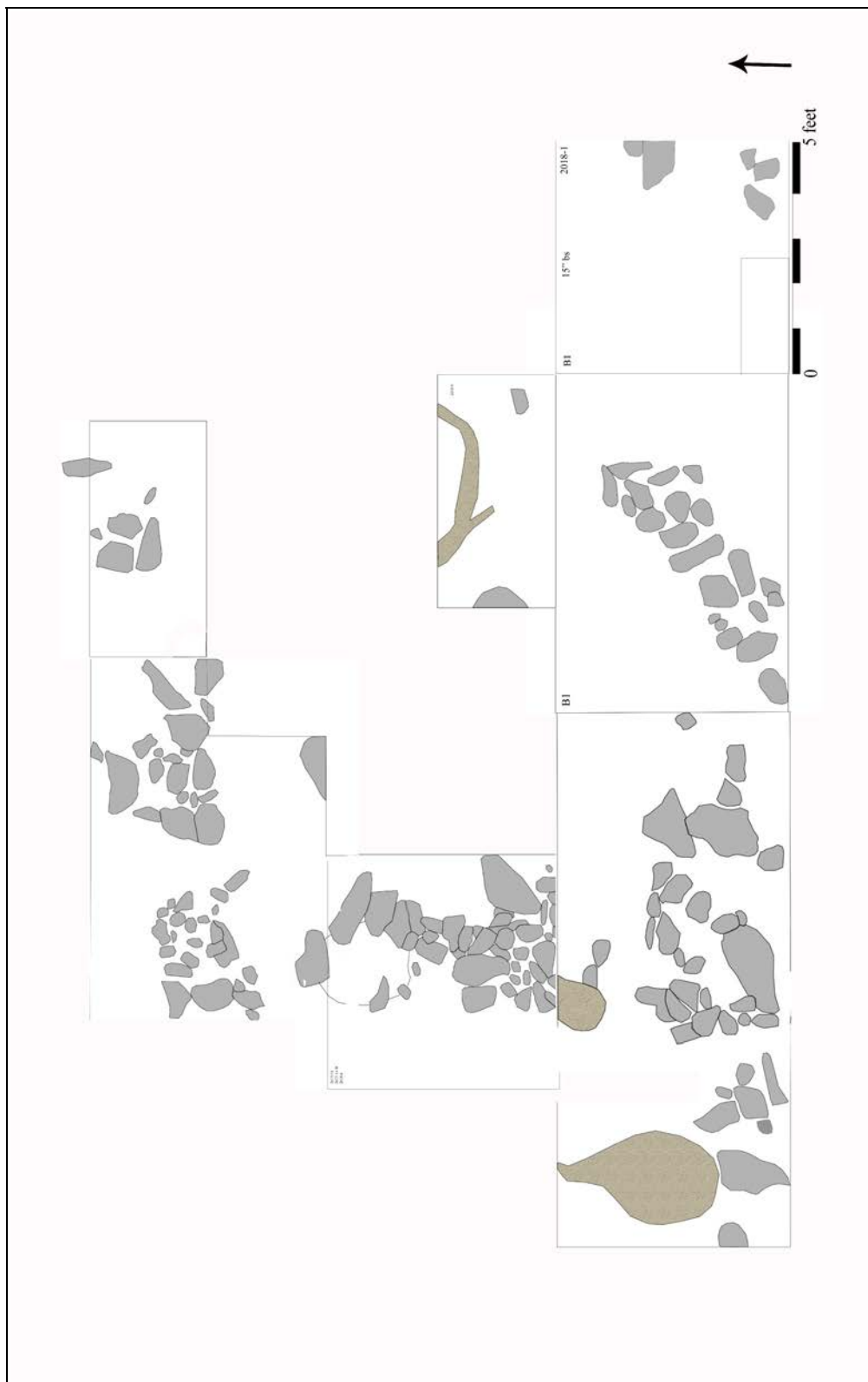

Figure 2. 2018 excavation area



Figure 3. Northern end of 2018 excavation area looking southwest.



Figure 4. Northern section of the 2018 excavation area looking southeast (Ray Duffy in background)



Figure 5. Western portion of the 2018 excavation area looking south (Feature 2 in the foreground).



Figure 6. Feature 2 plan and bisection photographs.

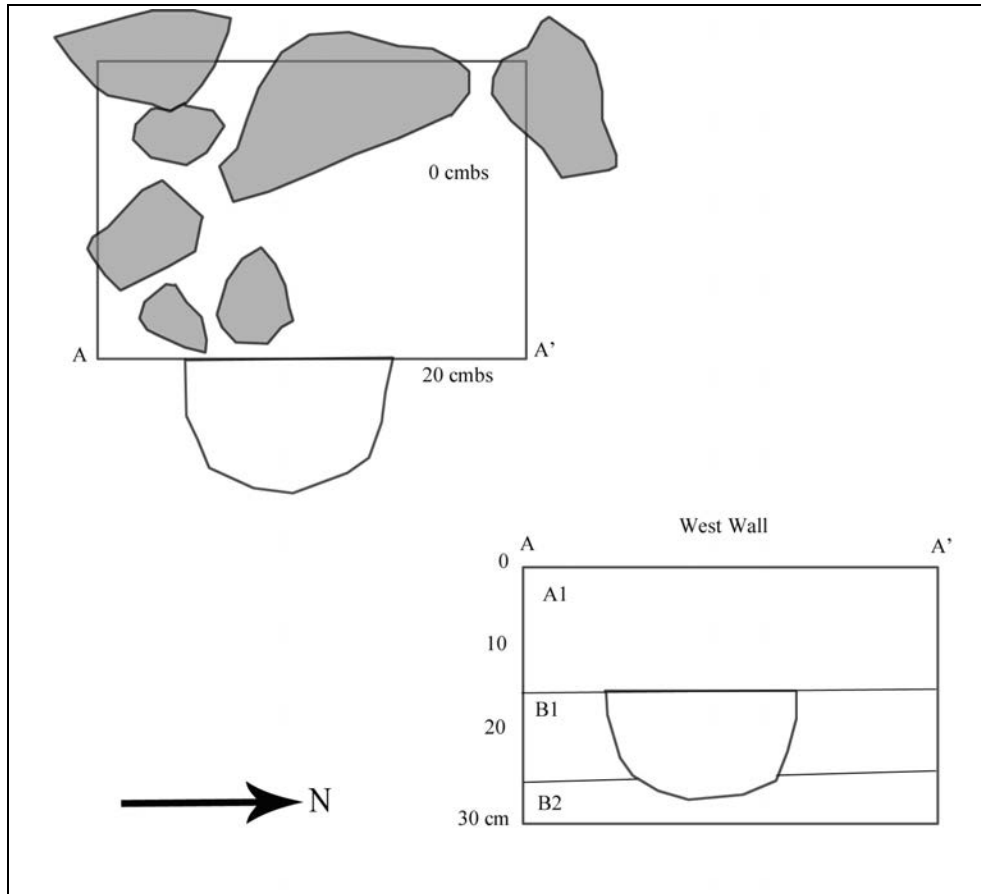

Figure 7. Feature 2 plan and bisection drawings.



Figure 8. Southern portion of the 2018 excavation area, cobble and rock platform.



Figure 9. Significant 2018 artifact recoveries (Top Row Left to Right: Rhyolite Levanna point; Native Shell-Tempered pottery; Tobacco pipe bowl with rouletted edge; Bottom Row: Brass mouth harp.

APPENDIX B
Artifact Catalog

Unit	Portion	Depth	Count	Class	Material	Identification	Portion	Color	Measurement	Notes
2017-11		6"	1	ceramic	brick	frags	half		10.8 cm wd 5.2 cm tk	
2017-11	SE	2-6"	2	ceramic	brick	frags	body Frag			
2017-11		6"	1	ceramic	brick	frags	half		10 cm wd 5 cm tk	
2017-11		6"	1	ceramic	brick	frags	body Frag			
2017-11		6"	20	Faunal	Shell	Soft Shell Clam	body Frag			
2017-11		6"	57	Faunal	Shell	Soft Shell Clam	umbo			
2017-11	SE	2-6"	1	Faunal	Shell	quahog	body Frag			
2017-11		6"	2	Faunal	Shell	quahog	body Frag			
2017-11		6"	2	Faunal	bone	cattle rib	mds			
2017-11		6"	1	Faunal	bone	swine M3	frag			unerupted
2017-11		6"	95	Faunal	Shell	Soft Shell Clam	chondrophore			
2017-11		6"	13	Faunal	Shell	quahog	hinge			
2017-11		6"	1	Faunal	bone	lg mam lngbn	mds			
2017-11		6"	1	ceramic	kaolin	pipe stem	frag		4/64" stem bore	
2017-11		6"	1	lithic	quartz	flake frag	plat miss	clr wht	1 cm wd	
2017-11		0-8"	1	lithic	rhyolite	flake frag	plat miss	maroon Prpl	1.4 cm wd	
2017-11	SE	2-6"	1	lithic	quartz	shatter	frag	wht clr	1.7 cm lg	
2017-14-W		0-6"	2	ceramic	brick	frags	body Frag			
2017-14-W		0-6"	1	ceramic	staff slipware	undec.	bdy			
2017-14-W		0-6"	1	Faunal	Shell	quahog	body Frag			
2017-14-W		0-6"	1	ceramic	redware	int/ ext glz	bdy	brown		
2017-14-W		0-6"	3	Faunal	bone	med mam lngbn	mds			
2017-14-W		0-6"	2	ceramic	redware	glz miss	bdy			
2017-14-W		0-6"	1	Faunal	bone	cattle Man M2 calf	complete			worn
2017-14-W		0-6"	3	Faunal	Shell	Soft Shell Clam	body Frag			
2017-14-W		0-6"	1	lithic	quartzite	flake frag	plat miss	dk Gy	1.7 cm wd	
2017-14-W		0-6"	1	lithic	quartz	shatter	frag	wht clr	1.5 cm lg	
2017-15	E, S1/2	0-8"	1	metal	iron	H wrought nails	complete		4 cm lg	
2017-15	E, S1/2	0-8"	3	metal	iron	H wrought nails	hds/ Shnks			
2017-15	E, S1/2	0-8"	1	Floral	Charcoal		frag			
2017-15	E, S1/2	0-8"	1	ceramic	redware	int/ ext glz	bdy	dk brown	10 cm body dia	mug with bands
2017-15	E, S1/2	0-8"	1	ceramic	kaolin	pipe stem	frag		4/64" stem bore	
2017-15	E, S1/2	0-8"	1	lithic	quartz	flake Frag	plat miss		1.7 cm wd	
2017-15	E, S1/2	0-8"	1	lithic	rhyolite	Flake	complete		30 dg pa 1.1 cm lg 1.2 cm wd	
2017-15	E, S1/2	0-8"	1	lithic	quartz	shatter	frag	wht Clr	3 cm lg	
2017-15	E, S1/2	0-8"	1	lithic	rhyolite	Uniface	complete		3.6 cm lg 2.3 cm wd	
2017-15	E, S1/2	0-8"	1	lithic	quartz	shatter	frag		1.3 cm lg	
2017-15-W	Fea 2	0-20 cm	1	metal	iron	H wrought nails	hds/ Shnks			
2017-15-W	Fea 2	20-30 cr	1	Floral	Charcoal		frag			
2017-15-W		0-6"	1	ceramic	brick	frags	body Frag			

2017-15-W	Fea 2	0-20 cm	1	Faunal	Shell	quahog	body Frag			
2017-15-W		0-6"	1	ceramic	redware	glz miss	body Frag			
2017-15-W		0-6"	3	Faunal	Shell	surf clam	chondrophore			
2017-15-W	Fea 2	0-20 cm	1	Faunal	Shell	Soft Shell Clam	body Frag			
2017-15-W		0-6"	1	Faunal	Shell	Soft Shell Clam	chondrophore			
2017-15-W		0-6"	1	Faunal	Shell	quahog	body Frag			
2017-15-W		0-6"	2	Faunal	Shell	Soft Shell Clam	body Frag			
2017-15-W		0-6"	1	Faunal	Shell	quahog	hinge			
2017-15-W		0-6"	2	ceramic	kaolin	pipe bowl	body Frag			
2017-15-W	Fea 2	0-20 cm	1	lithic	quartz	flake Frag	plat miss	clr wht	1.5 cm wd	
2017-15-W		0-6"	1	lithic	quartz	flake frag	plat miss	clr wht	1 cm wd	
2017-15-W		0-6"	1	lithic	rhyolite	flake frag	plat miss	purple gray	2 cm wd	
2018-1	cleanup	14"	1	ceramic	brick	frags	frag			
2018-1		4-8"	1	metal	iron	H wrought nails	complete		6 cm lg	
2018-1		4-8"	5	glass	flat	window	body Frag	aqua		
2018-1		0-10"	2	metal	iron	H wrought nails	hds/ Shnks			
2018-1		0-10"	1	glass	flat	window	body Frag	dark aqua		
2018-1		4-8"	6	metal	iron	H wrought nails	hds/ Shnks			
2018-1		4-8"	1	metal	iron	H wrought nails	complete		3 cm lg	
2018-1		4-8"	9	ceramic	brick	frags	body Frag			
2018-1		4-8"	1	metal	iron	H wrought nails	complete		4 cm lg	
2018-1		10"	1	metal	iron	H wrought nails	hds/ Shnks			
2018-1		0-10"	3	metal	iron	H wrought nails	shnks			
2018-1		4-8"	1	metal	iron	H wrought nails	complete		4.5 cm lg	
2018-1		4-8"	1	metal	iron	H wrought nails	shnk			
2018-1		4-8"	1	metal	iron	H wrought nails	complete		4 cm lg	
2018-1		4-8"	6	ceramic	redware	glz miss	body Frag			
2018-1		4-8"	2	ceramic	fulham	undec.	body Frag	white	10 cm body dia	mug with handle
2018-1		4-8"	1	Faunal	Shell	Soft Shell Clam	chondrophore			
2018-1		0-10"	1	ceramic	redware	int glz ext miss	bdy	brown		
2018-1		4-8"	1	glass	curved	hand blown	body Frag	olive		
2018-1		0-10"	3	ceramic	redware	glaze miss	bdy			
2018-1		0-10"	1	Faunal	bone	calc Med Mam fltbn	mds			
2018-1	cleanup		1	ceramic	redware	int glz ext unglz	body Frag	dk olive brwn		
2018-1		4-8"	1	metal	iron	buckle frame	frag		2.76 cm wd	
2018-1		4-8"	1	lithic	quartzite	Flake	complete	dk Gy	50 dg pa 1.7 cm lg 1.7 cm wd	cortex pres
2018-1		0-10"	1	lithic	rhyolite	flake frag	plat miss	dk gy	1.4 cm wd	
2018-1		4-8"	1	lithic	rhyolite	Flake	complete	dk Gy	50 dg pa 1.4 cm lg 1.7 cm wd	
2018-1		4-8"	1	lithic	rhyolite	Flake	complete	dk Gy	30 dg pa 1.7 cm lg 1.7 cm wd	
2018-1		0-10"	1	lithic	rhyolite	flake frag	plat miss	dk gy	1.7 cm wd	
2018-1		4-8"	1	lithic	rhyolite	flake Frag	plat miss	dk Gy	1.2 cm wd	
2018-1		4-8"	1	lithic	rhyolite	flake Frag	Plat prsnt	dk Gy	60 dg pa 1.5 cm wd	

2018-1		0-10"	1	lithic	rhyolite	flake frag	plat miss	dk gy	1 cm wd	
2018-1		0-10"	2	lithic	quartz	flake frag	plat miss	wht Clr	1.5, 1 cm wd	
2018-1		4-8"	1	lithic	rhyolite	Flake	complete	dk Gy	60 dg pa 1.1 cm lg 1.1 cm wd	
2018-1		4-8"	1	lithic	rhyolite	core	complete	dk Gy	5.7 cm lg 5.2 cm wd	cortex pres
2018-1		0-10"	1	lithic	rhyolite	flake frag	plat miss	dk gy	1.9 cm wd	
2018-1		4-8"	1	lithic	quartzite	flake Frag	plat miss	dk Gy	2.3 cm wd	cortex pres
2018-1		0-10"	1	lithic	quartz	shtr	frag	wht clr	1.7 cm lg	
2018-1		4-8"	4	lithic	quartz	shatter	frag	wht clr	1, 1.1, 1.3, 2 cm lg	
2018-1		4-8"	1	lithic	rhyolite	flake Frag	plat miss	dk Gy	2 cm wd	
2018-1		4-8"	1	lithic	rhyolite	flake Frag	plat miss	dk Gy	1.5 cm wd	
2018-1		0-10"	1	lithic	quartzite	shatter	frag	dk gy	2.8 cm lg	cortex pres
2018-1		4-8"	1	lithic	quartzite	flake Frag	plat miss	dk Gy	1.5 cm wd	
2018-1		0-10"	3	pottery	Shell-temp	int/ ext smooth	body Frag	tan	24 cm dby dia .7 cm tk	
2018-1		0-10"	1	lithic	rhyolite	levanna point	1 ear missing	maroon purple	3.5 cm lg .3 cm tk	
2018-1		4-8"	1	lithic	rhyolite	Flake	complete	dk Gy	55 dg pa 1.3 cm lg 1.1 cm wd	
2018-1		4-8"	1	lithic	rhyolite	flake Frag	plat miss	dk Gy	1.8 cm wd	
2018-1		4-8"	1	lithic	quartzite	flake Frag	plat miss	dk Gy	1.6 cm wd	
2018-1		4-8"	1	lithic	rhyolite	flake Frag	plat miss	dk Gy	1.7 cm wd	
2018-1		0-10"	1	lithic	rhyolite	flake frag	plat miss	dk gy	1.7 cm wd	
2018-2		0-10"	1	ceramic	brick	frags	body Frag			
2018-2	among ro	0-4"	2	ceramic	brick	frags	bdy			
2018-2		14" bs	2	Floral	Charcoal		frag			
2018-2	among ro	0-4"	2	metal	iron	H wrought nails	hds/ Shnks			
2018-2	among ro	0-4"	1	metal	iron	H wrought nails	complete		3 cm lg	
2018-2	among ro	0-4"	1	metal	brass	mouth harp	complete		6 cm lg 3 cm wd	
2018-2	among ro	0-4"	1	lithic	quartz	shatter	frag	clr wht	1.2 cm lg	
2018-2	among ro	0-4"	1	lithic	quartz	shatter	frag	clr wht	1.5 cm lg	
2018-2	among ro	0-4"	1	lithic	quartz	flake Frag	plat miss	clr wht	1 cm wd	
2018-2	among ro	0-4"	1	lithic	saugus jasper	shatter	frag	maroon Prpl	2 cm lg	
2018-2	among ro	0-4"	1	lithic	rhyolite	shatter	frag	dk gy	2.2 cm lg	
2018-2	among ro	0-4"	1	lithic	quartz	shatter	frag	clr wht	1.3 cm lg	
2018-2	among ro	0-4"	1	lithic	quartz	flake Frag	plat miss	clr wht	1 cm wd	
2018-3		down to	6	ceramic	brick	frags	frag			
2018-5		0-4"	1	ceramic	brick	frag	body Frag		5.2 cm tk	
2018-5		0-4"	1	ceramic	brick	frag	body Frag		5 cm tk	
2018-5		0-4"	1	metal	iron	H wrought nails	shank			
2018-5		0-4"	1	ceramic	brick	frag	body Frag		5 cm tk	
2018-5		0-10"	2	ceramic	brick	frags	body Frag			
2018-5	W1/2	4-6"	1	metal	iron	H wrought nails	complete		4.5 cm lg	
2018-5	W1/2	4-6"	1	metal	iron	H wrought nails	hds/ Shnks			

2018-5	W1/2	4-6"	3	glass	flat	window	body Frag	aqua		
2018-5		0-4"	1	ceramic	brick	frag	body Frag		5 cm tk	
2018-5		0-4"	15	ceramic	brick	frags	body Frag			
2018-5			1	ceramic	Tin-glazed	int dec blue	base	blue and wht		flatware
2018-5		0-4"	27	Faunal	Shell	Soft Shell Clam	body Frag			
2018-5			9	Faunal	Shell	Soft Shell Clam	chondrophore			
2018-5	W1/2	4-6"	2	Faunal	Shell	quahog	hinge			
2018-5			2	Faunal	Shell	quahog	body Frag			
2018-5			1	Faunal	bone	cattle metapod	mds			
2018-5			1	Faunal	bone	cattle thorasic vert	spine			
2018-5			1	Faunal	bone	cattle man M3	half			worn
2018-5			1	Faunal	bone	cattle max pm4	complete			worn
2018-5			1	Faunal	bone	sheep rib	Mids			
2018-5			2	Faunal	Shell	Soft Shell Clam	umbo			
2018-5			6	Faunal	Shell	quahog	hinge			
2018-5		0-10"	3	Faunal	Shell	Soft Shell Clam	chondrophore			
2018-5		0-4"	4	Faunal	Shell	quahog	hinge			
2018-5		0-4"	3	Faunal	Shell	quahog	body Frag			
2018-5	W1/2	4-6"	1	Faunal	Shell	Soft Shell Clam	chondrophore			
2018-5			1	Faunal	bone	med Mam fltbn				
2018-5		0-4"	43	Faunal	Shell	Soft Shell Clam	chondrophore			
2018-5	W1/2	4-6"	1	Faunal	bone	swine tibia	distal			unfused chopped
2018-5		0-10"	1	Faunal	Shell	quahog	hinge			
2018-5	W1/2	4-6"	1	Faunal	bone	small duck sp. Humeru	complete		4 cm lg	
2018-5		0-4"	18	Faunal	Shell	Soft Shell Clam	umbo			
2018-5	W1/2	4-6"	2	ceramic	kaolin	pipe bowl	body Frag			small belly bowl
2018-5		0-10"	1	lithic	rhyolite	flake Frag	plat miss		1.6 cm wd	
2018-5	W1/2	4-6"	1	lithic	saugus jasper	Flake	complete	maroon Prpl	80 dg pa 1.3 cm lg 1 cm wd	
2018-5			1	lithic	rhyolite	flake frag	plat miss	dk Gy	1.5 cm wd	
2018-5		0-10"	2	lithic	quartz	shatter	frag	clr wht	2, 2.5 cm lg	
2018-5	W1/2	4-6"	1	lithic	quartz	shatter	frag	clr Wht	2.5 cm lg	
2018-6		0-4"	1	ceramic	brick	frags	frag			
2018-6		0-4"	1	metal	iron	H wrought nails	hds/ Shnks			
2018-6		0-6"	4	ceramic	brick	frags	body Frag			
2018-6		0-4"	2	metal	iron	H wrought nails	hds/ Shnks			
2018-6		0-4"	3	glass	flat	window	body Frag	aqua		
2018-6		0-6"	34	mortar	Shell-temp	frags	frag			soft shell clam temper
2018-6		0-4"	17	ceramic	brick	frags	body Frag			
2018-6		4-6"	1	ceramic	brick	frags	bdy			
2018-6		0-4"	4	metal	iron	H wrought nails	shank			
2018-6		0-6"	4	Floral	Charcoal	frags	frag			
2018-6		4-6"	20	Faunal	bone	med Mam fltbn	mds			

2018-6	0-6"	4	Faunal	bone	med mam lngbn	mds			
2018-6	4-6"	4	Faunal	bone	med Mam fltbn	mds			
2018-6	4-6"	3	Faunal	bone	med mam lngbn	mds			
2018-6	0-4"	11	Faunal	Shell	Soft Shell Clam	body Frag			
2018-6	4-6"	1	Faunal	Shell	quahog	hinge			
2018-6	0-4"	1	Faunal	bone	swine scapula	Mids			
2018-6	0-4"	2	Faunal	Shell	quahog	body Frag			
2018-6	0-6"	3	Faunal	bone	sheep M2	frags			
2018-6	4-6"	10	Faunal	bone	med mam lngbn	mds			
2018-6	0-4"	1	Faunal	bone	cattle cranial	ossicle			
2018-6	0-4"	1	ceramic	redware	int glz ext miss	body Frag	dk olive		
2018-6	0-6"	18	Faunal	Shell	Soft Shell Clam	body Frag			
2018-6	4-6"	1	Faunal	bone	cattle man m2	complete			worn
2018-6	4-6"	2	Faunal	bone	cattle rib	mds			
2018-6	0-6"	8	Faunal	Shell	Soft Shell Clam	body Frag			burned
2018-6	0-4"	1	Faunal	bone	cattle cranial	orbit			
2018-6	0-6"	1	Faunal	Shell	quahog	body Frag			
2018-6	0-4"	1	Faunal	bone	med Mam fltbn	frag			
2018-6	4-6"	1	Faunal	bone	swine M3	frag			unerupted
2018-6	4-6"	1	Faunal	bone	sheep pelvis	mds			
2018-6	0-6"	4	ceramic	redware	glz miss	body Frag			
2018-6	0-6"	2	Faunal	Shell	Soft Shell Clam	umbo			
2018-6	4-6"	1	Faunal	bone	swine radius	proximal			
2018-6	4-6"	1	Faunal	bone	cattle Max M3	complete			unerupted
2018-6	4-6"	1	Faunal	bone	cattle phalange 3	proximal			
2018-6	4-6"	1	Faunal	bone	cattle Max M3	complete			unerupted
2018-6	4-6"	1	Faunal	Shell	Soft Shell Clam	umbo			
2018-6	0-6"	19	Faunal	bone	sheep cranial	frags			
2018-6	4-6"	1	Faunal	Shell	Soft Shell Clam	chondrophore			
2018-6	4-6"	1	Faunal	bone	cattle M	frag			unerupted
2018-6	0-4"	1	ceramic	redware	glaze miss	body Frag			
2018-6	0-4"	1	Faunal	Shell	Soft Shell Clam	umbo			
2018-6	0-6"	13	Faunal	Shell	Soft Shell Clam	chondrophore			
2018-6	4-6"	1	Faunal	bone	cattle pelvis	mds			
2018-6	4-6"	1	Faunal	bone	swine ulna prox	frag			
2018-6	0-4"	1	ceramic	kaolin	pipe bowl	rim and body			roulette at rim late 17 th
2018-6	0-6"	1	lithic	rhyolite	flake Frag	plat miss	dk gy	2 cm wd	
2018-6	0-6"	1	lithic	quartz	core	Frag	wht clr	5 cm lg	
2018-6	0-6"	1	lithic	quartz	core	Frag	wht clr	7 cm lg	
2018-6	4-6"	1	lithic	quartz	shtr	frag	wht clr	9 cm lg	
2018-6	4-6"	1	lithic	rhyolite	flake frag	plat miss	dk prpl gy	1.5 cm wd	
2018-6	0-6"	1	lithic	quartz	shatter	frag	wht clr	3 cm lg	
2018-6	0-6"	1	lithic	rhyolite	flake Frag	plat miss	dk maroon prpl	2 cm wd	

2018-6		0-6"	1	lithic	rhyolite	flake Frag	plat miss	dk gy	2.5 cm wd	
2018-6		0-6"	1	lithic	quartz	shatter	frag	wht clr	3 cm lg	
2018-6		0-6"	1	lithic	rhyolite	flake Frag	plat miss	gy	2 cm wd	
2018-6		0-6"	1	lithic	quartz	flake Frag	plat miss	wht clr	3.5 cm wd	cortex pres
2018-6		4-6"	1	lithic	quartz	core	frag	wht clr	7.5 cm lg	
2018-6		0-6"	1	lithic	quartz	flake Frag	plat miss	wht clr	1 cm wd	
2018-7		0-4"	1	Faunal	Shell	quahog	hinge			
2018-7		0-4"	2	ceramic	redware	int/ ext glz	bdy	dk brown	10 cm body dia	mug with bands
2018-7		0-4"	1	ceramic	fulham	undec.	bdy			
2018-7		0-4"	2	lithic	quartz	shatter	frag	clr wht	1.7, 2.5 cm lg	
2018-8	SE	4-6"	1	ceramic	brick	frag	frag			
2018-8		6-12"	1	ceramic	brick	frags	half		10.2 cm wd 5.4 cm tk	
2018-8	SE	4-6"	1	metal	iron	H wrought nails	complete		5.5 cm lg	
2018-8		0-6"	1	ceramic	brick	frags	body Frag			
2018-8	SE	4-6"	4	Faunal	Shell	quahog	body Frag			
2018-8		0-6"	1	Faunal	Shell	moon snail	whorl			
2018-8		0-6"	1	Faunal	Shell	Soft Shell Clam	body Frag			
2018-8	SE	4-6"	3	ceramic	redware	int miss ext unglz	body Frag			
2018-8	SE	4-6"	1	Faunal	Shell	quahog	hinge			
2018-8		4-6"	1	Faunal	Shell	quahog	body Frag			
2018-8	SE	4-6"	1	lithic	saugus jaspe	Flake	complete	maroon Prpl	70 dg pa 2.5 cm lg 1.1 cm wd	
2018-8	SE	4-6"	2	lithic	quartz	shatter	frag	wht Clr	3 cm lg	
2018-8	SE	4-6"	1	lithic	quartzite	Flake	complete	dk gy	60 dg pa 1.4 cm lg 1.7 cm wd	
2018-9		0-8"	1	glass	flat	window	body Frag	aqua		
2018-9		0-8"	3	metal	iron	H wrought nails	hds/ Shnks			
2018-9		0-8"	1	ceramic	brick	edge	frag			
2018-9		0-8"	3	metal	iron	H wrought nails	shanks			
2018-9		0-8"	1	ceramic	brick	frag	frag		5.7 cm tk	
2018-9		0-8"	1	ceramic	redware	int/ ext glz	body Frag	dark olive	10 cm body dia	mug with bands
2018-9		0-6"	1	Faunal	bone	calc Med Mam fltbn	Mids			
2018-9		0-6"	1	ceramic	redware	int unglz ext glz	body Frag	dk olive		
2018-9		6-13"	1	ceramic	scraffito	ext dec	body Frag	yellow		
2018-9		0-8"	1	ceramic	redware	int/ ext glz	body Frag	tan		
2018-9		0-8"	1	glass	curved	wine bottle	body Frag	dark olive		old?
2018-9		0-8"	1	lithic	flint	gunflint- bifacial	complete	gray	2.2 cm lg 1.4 cm wd	
2018-9		0-8"	1	pottery	Shell-temp	int sm ext miss	body Frag	tan		
2018-9		0-8"	1	lithic	quartz	squibnocket triangle	body ear	wht Clr	.4 cm tk	reworked
2018-9		0-8"	1	lithic	quartzite	flake Frag	plat miss	dk gy	1.5 cm wd	
2018-9		0-8"	3	lithic	quartz	flake frags	plat miss	wht Clr	1.1, 1.2, 2.4 cm wd	
2018-9		0-6"	1	lithic	rhyolite	flake frag	plat miss	dk prpl gy	1.6 cm wd	

2018-9		0-8"	1	lithic	rhyolite	flake Frag	plat miss	dk gy	1.5 cm wd	
2018-9		0-6"	1	lithic	quartz	shatter	frag	wht clr	2 cm lg	
2018-9		0-6"	1	lithic	quartz	shatter	frag	wht clr	3.3 cm lg	
2018-9		0-8"	1	lithic	rhyolite	flake Frag	plat miss	dk gy	2.1 cm wd	
2018-9		0-8"	1	lithic	rhyolite	flake Frag	plat miss	ppl gy	2 cm wd	
2018-9		0-8"	1	lithic	rhyolite	flake Frag	plat miss	dk gy	1.1 cm wd	
2018-9		0-8"	1	lithic	quartz	flake frag	plat miss	clr	1.2 cm wd	
2018-9		0-6"	1	lithic	rhyolite	shatter	frag	gray	1.6 cm lg	cortex pres
2018-9		0-8"	1	lithic	rhyolite	Flake	complete	dk gy	50 dg pa 1.6 cm lg 1 cm wd	
2018-9		0-8"	1	lithic	rhyolite	flake Frag	plat miss	dk gy	.7 cm wd	
2018-9		0-8"	1	lithic	rhyolite	flake Frag	plat miss	dk gy	.7 cm wd	
2018-9		6-13"	1	lithic	quartz	flake frag	plat miss	wht clr	1.2 cm wd	
2018-9		0-8"	1	lithic	rhyolite	Flake	complete	dk gy	45 dg pa 1.2 cm lg 1.1 cm wd	
2018-10		0-6"	2	metal	iron	H wrought nails	hds/ Shnks			
2018-10		0-6"	1	glass	flat	window	body Frag	aqua		
2018-10		0-6"	1	Faunal	Shell	Soft Shell Clam	umbo			
2018-10		0-6"	2	Faunal	bone	med mam Ingbn	mds			
2018-10		0-6"	5	Faunal	Shell	quahog	body Frag			
2018-10		0-6"	1	Faunal	Shell	Soft Shell Clam	chondrophore			
2018-10		0-6"	2	Faunal	Shell	Soft Shell Clam	body Frag			
2018-10		0-6"	1	lithic	flint	shatter	frag	lt gy	3 cm lg	
2018-10		0-6"	1	lithic	saugus jasper	flake frag	plat miss	maroon Prpl	1 cm wd	
2018-10		0-6"	1	lithic	quartzite	flake Frag	plat miss	dk gy	1.2 cm wd	
2018-10		0-6"	2	lithic	quartz	shatter	frag	clr Wht	2.8, 3.5 cm lg	
2018-10		0-6"	1	lithic	quartz	shatter	frag	wht clr	3.5 cm lg	
2018-10		0-6"	1	lithic	rhyolite	flake frag	plat miss	gray	1.8 cm wd	
2018-10		0-6"	1	lithic	quartz	shatter	frag	wht clr	1.3 cm lg	
2018-10		0-6"	1	lithic	quartz	shatter	frag	wht clr	1.7 cm lg	
2018-10		0-6"	1	lithic	quartz	Flake	complete	clr Wht	80 dg pa 2.5 cm lg 3 cm wd	